



## SAMPLE COOLERS

### DESIGN FEATURES

- ISO 9001 Certified by Underwriters Laboratories
- **CONTINUOUS COIL DESIGN** - No internal coil connections to leak or require maintenance
- **HEAVY DUTY**- All stainless steel coils of 316 SS rated to 5000 psig @ 1000°F
- **SERVICEABLE** – Removable shell allows inspection and cleaning. Cooler connections allow for easy removal.
- **CLOSE APPROACH TEMPERATURE** - Design maximizes cooling water/coil contact and minimizes fouling
- **GASKETS** – Non-Asbestos, High Temperature
- **SHELL AND END PLATES** – Carbon Steel standard. 304 SS available as an option
- **ASME CODE STAMP** – Available as an option



The sample coolers manufactured by Johnson March Systems have a long and proven history of leak free reliable performance. They are used in the Power, Petrochemical and Industrial markets throughout the world. To ensure customer satisfaction we offer several sizes along with optional shell and tube materials.

### DESIGN CRITERIA

MODEL	TUBE RATING	SHELL RATING	SQ. FT.	WT. LBS.
25020	5000 psig @ 1000°F	500 psig @ 650°F	1.2	16 lbs.
25040	5000 psig @ 1000°F	500 psig @ 650°F	2.4	20 lbs.
37520	5000 psig @ 1000°F	500 psig @ 650°F	1.8	35 lbs.
37540	5000 psig @ 1000°F	500 psig @ 650°F	3.5	39 lbs.

### MATERIAL OF CONSTRUCTION

MODEL	SHELL MATERIAL	TOP/BOTTOM FLANGE	TUBE MATERIAL	GASKET MATERIAL
25020	CARBON STEEL	CARBON STEEL	1/4" O.D. 316SS	NON-ASBESTOS
25040	CARBON STEEL	CARBON STEEL	1/4" O.D. 316SS	NON-ASBESTOS
37520	CARBON STEEL	CARBON STEEL	3/8" O.D. 316SS	NON-ASBESTOS
37540	CARBON STEEL	CARBON STEEL	3/8" O.D. 316SS	NON-ASBESTOS

Note: Add "SS" Suffix to the Model Number for 304SS Shell, top flange and bottom flange material

### AVAILABLE OPTIONS

- ASME VIII CODE STAMP
- STAINLESS STEEL HARDWARE
- SPECIAL PAINT
- INCONEL TUBE MATERIAL
- MOUNTING BRACKET
- MATERIAL CERTIFICATION



220 RAILROAD DRIVE  
 IVYLAND PA 18974 USA  
 (215) 364-2500  
 FAX (215) 364-5425  
 WWW.JOHNSONMARCH.COM  
 ISO 9001 CERTIFIED



# JOHNSON MARCH SYSTEMS, INC.

## COOLER PERFORMANCE

Sample Flow Rate cc/min	MODEL 25020			MODEL 25040			MODEL 37520			MODEL 37540		
<b>SAMPLE OUTLET TEMPERATURE ° F BASED ON 95°F COOLING WATER</b>												
500	101	104	105	96	96	96	100	102	102.5	95.5	96	96.5
1000	107	118	138	96	97	98	106	107.5	129	96	97	98.5
1500	117	145	---	97	99	115	113	133	---	97	98	101
2000	135	185	---	102	108	---	125	160	---	98	100	107
	7 GPM COOLING WATER			7 GPM COOLING WATER			12 GPM COOLING WATER			12 GPM COOLING WATER		

### ORDERING INFORMATION

- **MODEL NUMBER**
- **MEDIUM TO BE COOLED**  
Sample pressure  
Sample Temperature
- **SAMPLE FLOW**  
Design flow for sample
- **COOLING WATER**  
Temperature  
Flow Available
- **OPTIONS**  
304SS Shell Material  
ASME Code Stamp  
304SS Hardware  
Special Paint  
Inconel Sample Tube  
Material Certifications  
Mounting Bracket
- For further information and ordering, email to [parts@johnsonmarch.com](mailto:parts@johnsonmarch.com)

MODEL NO  
25020 / 25020SS  
25040 / 25040SS

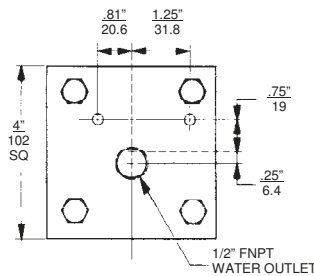

MODEL NO  
37520 / 37520SS  
37540 / 37540SS

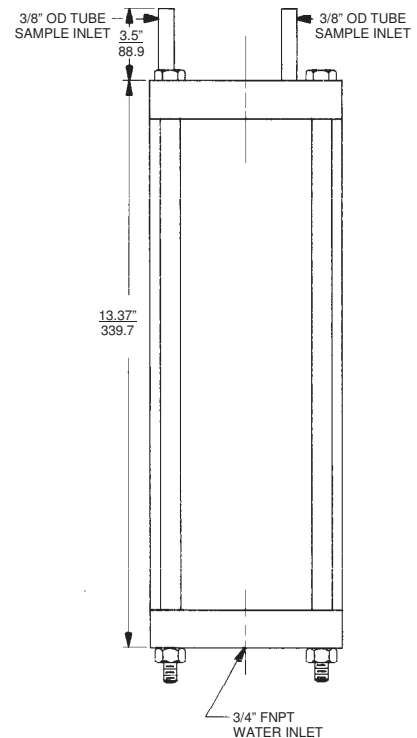
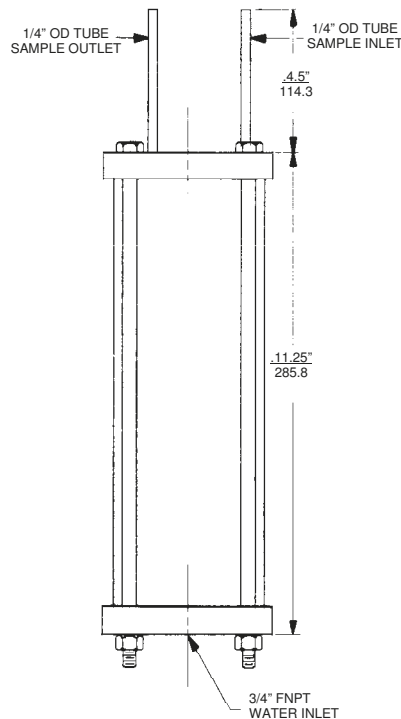
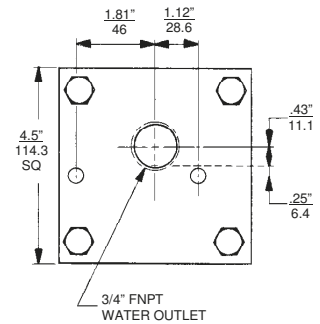

220 RAILROAD DRIVE  
IVYLAND PA 18974 USA  
(215) 364-2500  
FAX (215) 364-5425  
WWW.JOHNSONMARCH.COM  
ISO 9001 CERTIFIED